

LEGEND

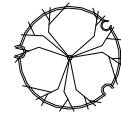

- LARGE TREE 6-8 m spacing**
- Aristotelia serrata (Wineberry)
 - Coprosma linearifolia (Mikimiki)
 - Fuschia excorticata (Kotukutuku)
 - Metrosideros umbellata (Southern Rata)
 - Nothofagus fusca (Red Beech)
 - Nothofagus solandri (Mountain Beech)



- SMALL TREE/ LARGE SHRUB 3-4 m spacing**
- Cordyline australia (Cabbage Tree)
 - Griselinia littoralis (Broadleaf Papaumu)
 - Hoheria lyallii (Mountain Ribbonwood)
 - Kunzea ericoides (Kanuka)
 - Leptospermum scoparium (Manuka)
 - Melicytus laceolatus (Mahoe Wao)
 - Olearia hectorii (Hector's Tree)
 - Olearia paniculata (Golden Ake Ake)
 - Pittosporum eugenioides (Lemonwood)
 - Pseudopanax crassifolius (Lancewood)
 - Sophora microphylla (Kowhai)



- SHRUB 1-2 m spacing**
- Aristotelia fruticosa (Mountain Wineberry)
 - Carmichaelia petrei (NZ Broom)
 - Discaria toumatou (Matagouri)
 - Hebe cupressoides (Cypress Hebe)
 - Melicytus alpinus (Porcupine Bush)
 - Pimelia aridula (NZ daisy)

GRASS - Group 1

- Aciphylla glaucescens (Blue Speargrass)
- Carex maoica (Carex)
- Juncus gregiflorus (NZ Soft Rush)

GRASS - Group 2

- Chionochloa conspicua (Bush Tussock)
- Chionochloa rigida (Snow Tussock)
- Chionochloa rubra (Red Tussock)

GRASS - Group 3

- Astelia nervosa (Mountain Astelia)
- Carex secta (Purei)
- Phormium cookianum (Mountain Flax)

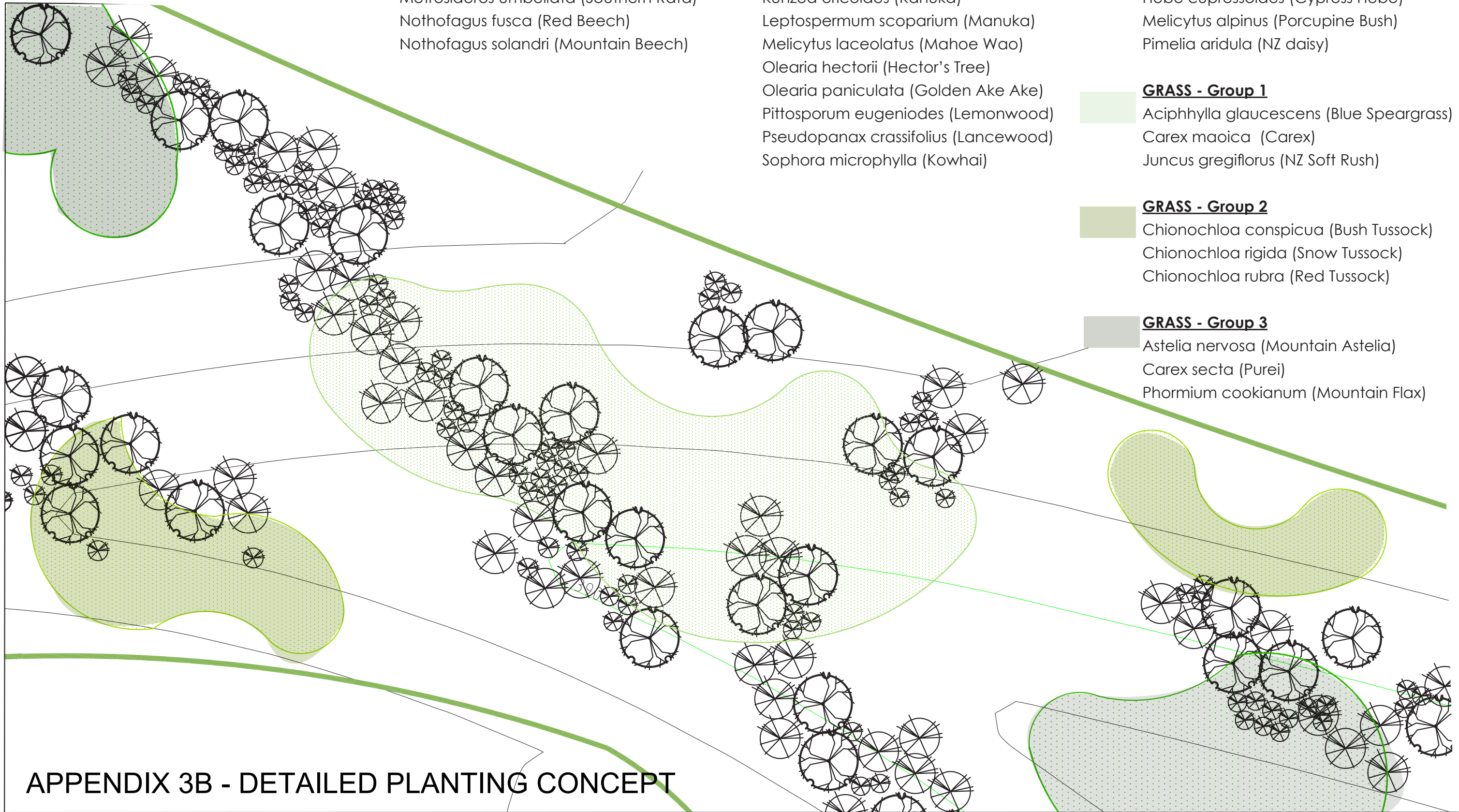

APPENDIX 3B - DETAILED PLANTING CONCEPT

Landscape Berm Planting Concept Homestead Bay, Jack's Point



REF: 1171-L2
DATE: April 20, 2017
SCALE: n.t.s.

vivian+espie

resource management and landscape planning
vivan+espie Limited Resource Management and Landscape Planning
PO Box 2514
Physical Address Unit 15 70 Glenda Drive Frankton, Queenstown
Tel +64 3 441 4189 Fax +64 3 441 4190 Web www.vivianespie.co.nz